

CARTER + CO



3/8 Edmond Close Gilmore ACT

3  2  2 

Nestled within a boutique development of only three townhouses, this meticulously crafted residence presents an unparalleled opportunity for comfortable, contemporary living. Ideally positioned in a sought-after location, this property offers the perfect blend of convenience, privacy and comfort.

Featuring a functional U shaped kitchen with quality appliances including externally ducted range hood, 4 burner gas cook top, oven, AEG dishwasher and double bowl sink. Impressive energy efficiency rating of 6 stars which is the maximum rating for residential properties, when required this home comes equipped with ducted heating throughout.

With vacant possession this is the perfect opportunity for someone looking to downsize or a first home buyer looking

Price : \$ 751,000

View : <https://www.carterandcoagents.com.au/sale/act/tuggeranong/gilmore/residential/townhouse/7912966>



Sam Howes
02 6176 3443

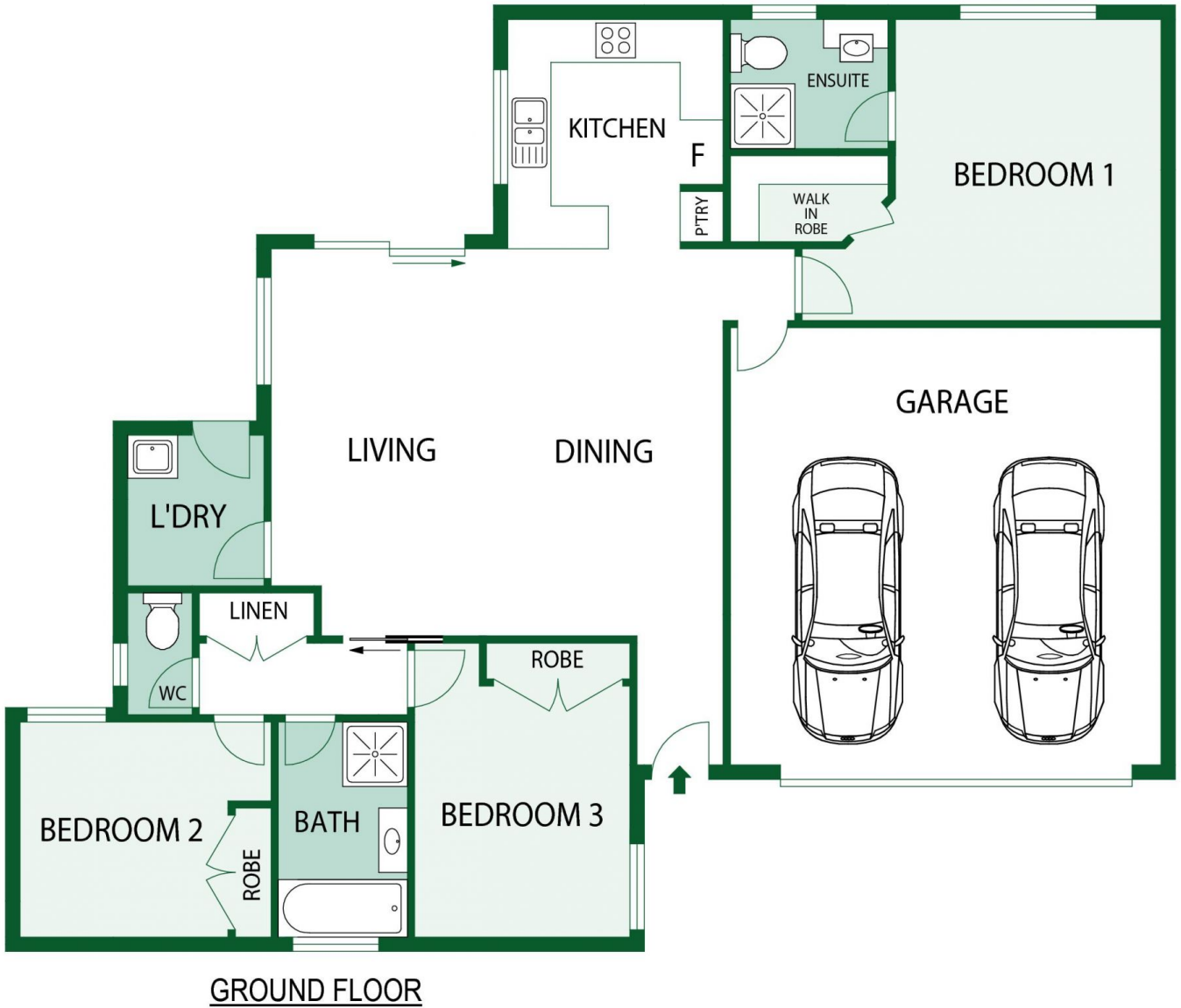

APPROX : INTERNAL AREA :- 118.6 SQM
 APPROX : GARAGE AREA :- 39.1 SQM

3/8 Edmond Close,

Floor Plan Disclaimer: This floor plan/site plan are intended as an approximate guide only. No representations or warranties of any nature are given or intended and any person using this information other than as a guide should always rely on their own enquiries.