

CARTER + CO



27 Novar Street Yarralumla ACT

5 2 5

Nestled in the heart of the highly sought-after Inner-South, this beautiful Yarralumla residence sitting on an expansive 862m² parcel of land, offers a northerly aspect living areas as well as a luxurious lifestyle within reach of Canberra's finest attractions.

Boasting proximity to Parliament House, the Parliamentary Triangle, and Embassy precincts, as well as an array of esteemed Government and Private schools, this residence presents an unparalleled opportunity for discerning buyers.

Situated amidst the vibrant pulse of café society, Yacht Club, and the prestigious Royal Canberra Golf Club, this residence offers a lifestyle of convenience and leisure with easy access to rowing facilities and water sports, enriching every day with activities for all tastes.

Building Size : 300 sqm
Land Size : 862 sqm
View : <https://www.carterandcoagents.com.au/sale/act/inner-south/yarralumla/residential/house/7919218>



Maria Selleck
02 6176 3443

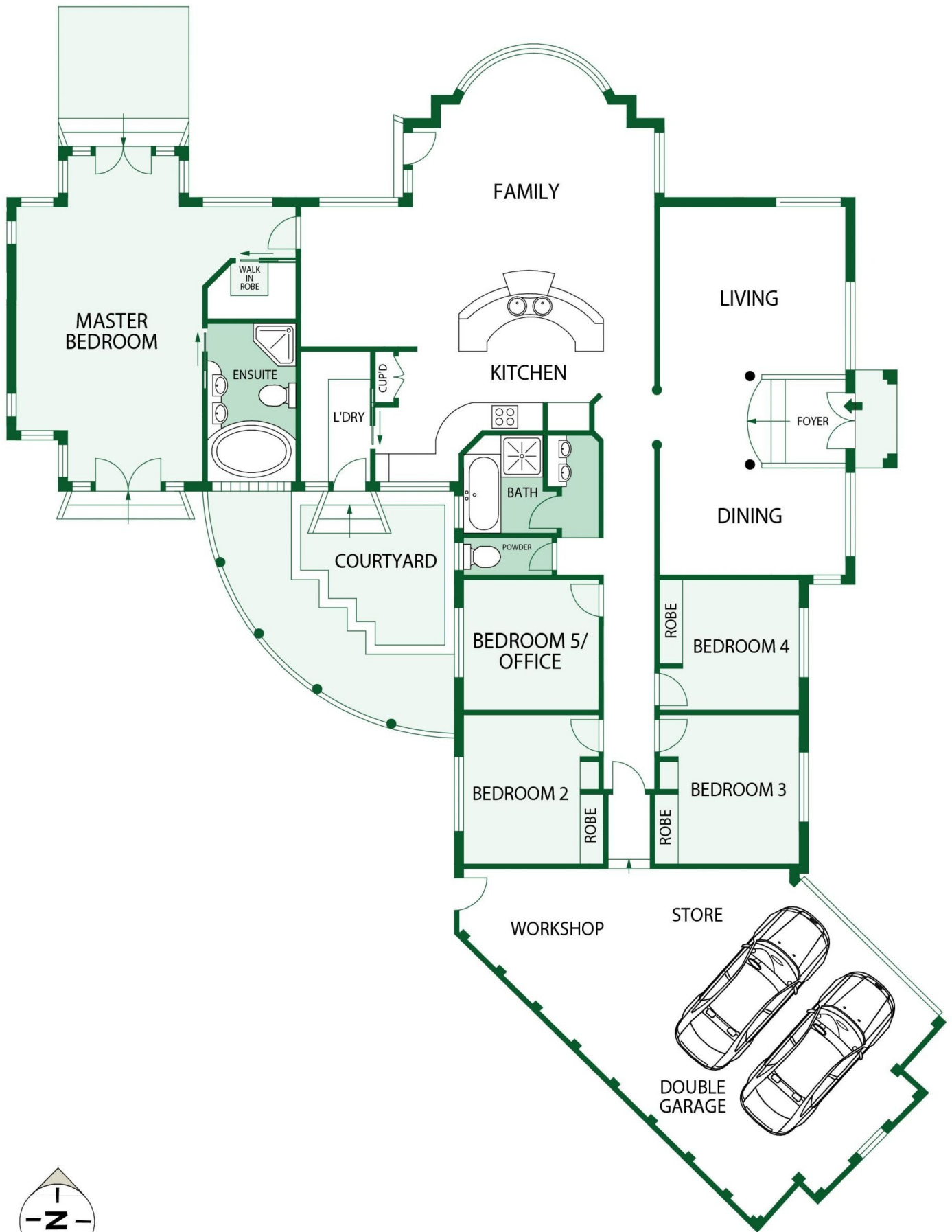

27 Novar Street, Yarralumla

Floor Plan Disclaimer: This floor plan/site plan are intended as an approximate guide only. No representations or warranties of any nature are given or intended and any person using this information other than as a guide should always rely on their own enquiries.